

# SURVEYOR'S RECORD

Section 34

Township 106

Range 41

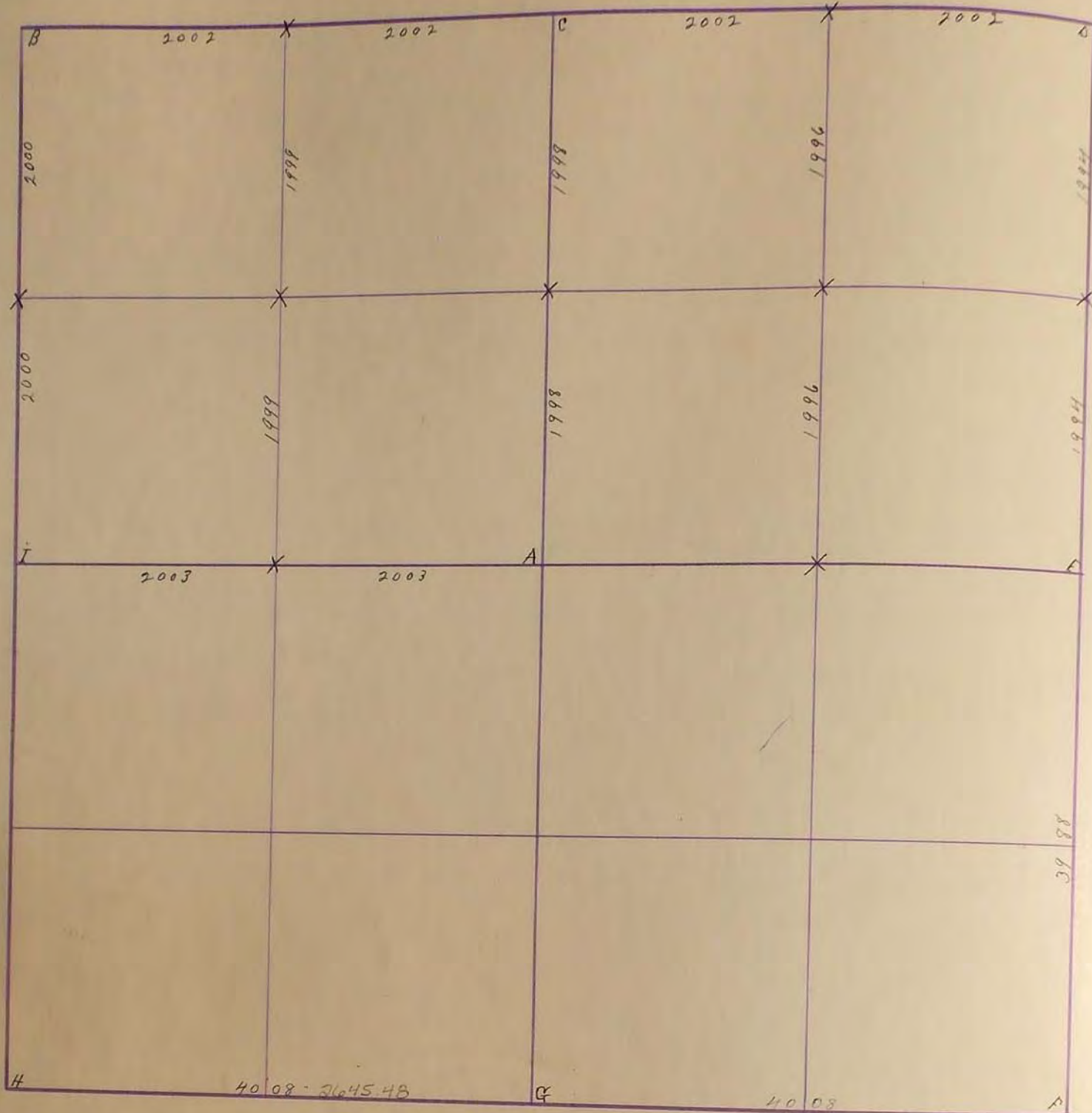

April 17-1898

- A Stone and Pits
- B. Gov. Mound and Pits
- C Stone and Pits. Fence 29.5° S 2° E July 5 1918 J. H. H.
- D " in grade Iron Rod & B.R. Spike Filed x in C.M.P. 37.48 N.E.
- E " in road Filed x in C.M.P. 37.23 S.E. Filed x in C.M.P. 36.85 S.W.
- F stake in grade
- G. stake 6' E of Bridge on N side of grade
- H. Gov. Mound and Pits
- I Stone and Pits
- X " " "

J. H. Hoolstina soft

- I. "Found field stone 18" down. Placed Iron pin" 9-1-78  
RP. N+e in Cor. P. W. 41.31 - N+e in PP. N.W. 51.50
- B. Found 2 7x2" hubs with bottle between, Placed 9-5-78  
Iron pin above. RP N+e in top N.E. 62.34  
N+e in PP. N.W. 68.50 N+e in PP. S.W. 52.12

34  
35

SURVEY No. 302

Section 34 Town 106 Range 111

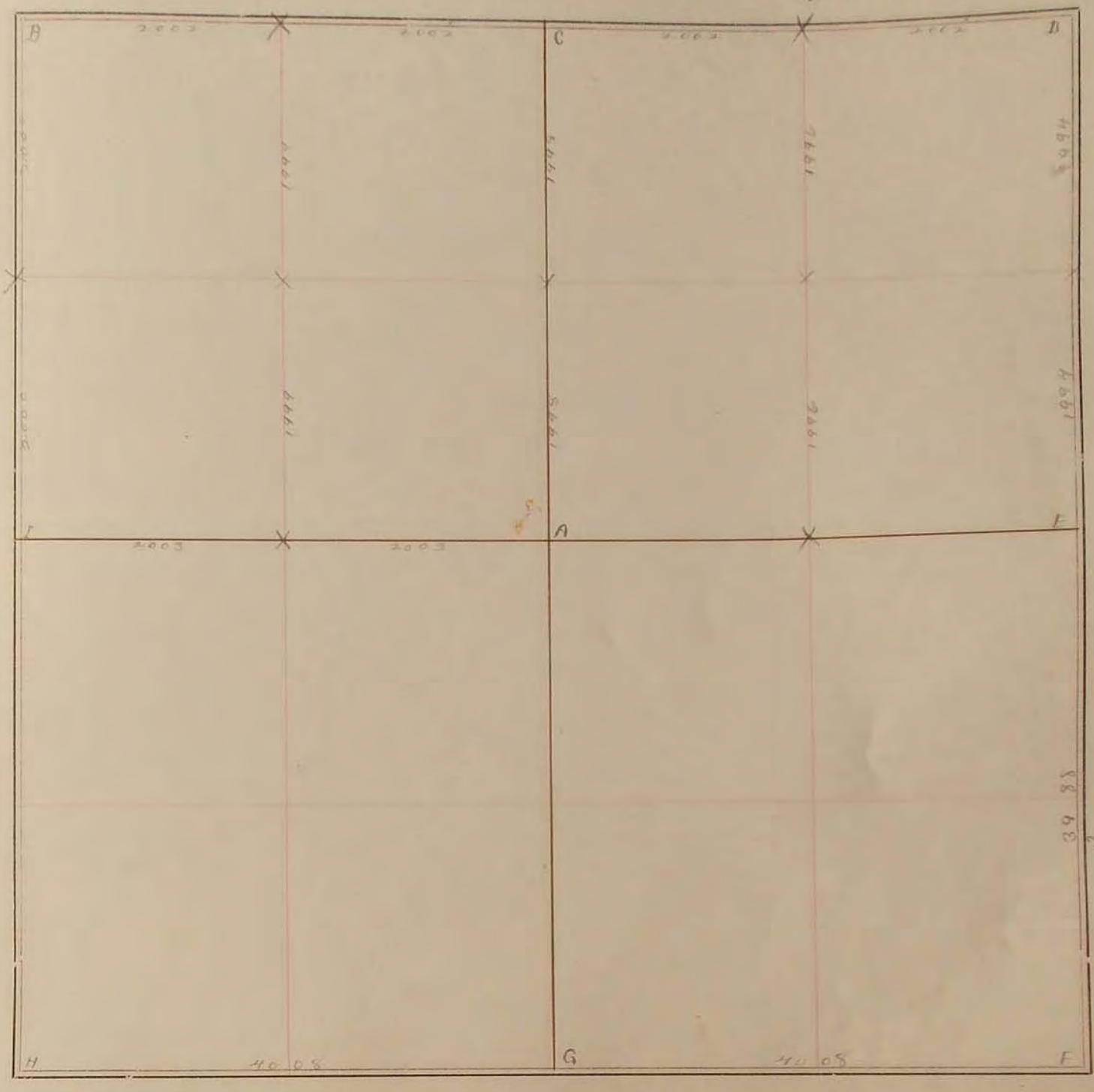

FIELD NOTES.

April 12, 1898.

- A. Stone + pits.
- B. Gov. mound + pits.
- C. Stone + pits. FENCE 29.5 S + 2'E. July 5, 1916. J.W.W.
- D. " in grade.
- E. " in road
- F. Stake in grade
- G. Stake 6' east of bridge on north side of grade.
- H. Gov. mound + pits.
- I. Stone + pits.
- X. " " "

J.W. Woodsten and J.T.